Chardon Local Schools

Reconfiguration Planning

December 19, 2017



Purpose



Background



Why Reconfiguration?

- To address declining enrollment
- To increase operational efficiency
- To provide greater curricular opportunities for students while containing cost.
- To maintain focus on our mission:

*High Achievement for All Students,
Where Learning is Our Most
Important Work*

Strategic Plan

Vision 2020



Strategic Plan Board adopted in November 2015.

Resources

Chardon Local Schools will maximize the capacity, effectiveness and efficiency of all our current and future resources.

Implementation Strategy #4

“Study staffing, enrollment, building capacities and grade level structure for recommendations to improve programmatic effectiveness, operational efficiency, and fiscal stability.”

Evaluation of district reconfiguration has been a working goal in our strategic plan for several years.

Timeline



Timeline

Past



November, 2015	October, 2016	February, 2017	May, 2017
<p>District Strategic Plan (Vision 2020) adopted identifying need to study enrollment and grade configuration.</p>	<p>District Facilities Committee begins meeting.</p> <p>OFCC completes assessment of school facilities recommending replacement with fewer schools.</p> <p>Purpose of assessing current facilities and master plan concepts.</p>	<p>As part of the District Facilities Committee work, an enrollment projection is commissioned with DeJong Healy.</p>	<p>District Facilities Committee recommends a new two-building master plan Pk-6/7 and 7/12.</p> <p>Work is put on hold, pending ballot-issue for operating expenses (Issue 26)</p>

Timeline

Present



August, 2017	October, 2017	November 15, 2017	December, 2017
<p>District announces intent to form Enrollment Taskforce with purpose of assessing enrollment trends and considering reconfiguration concepts.</p> <p>Principals identify teacher and parent representatives to serve on task force.</p>	<p>Enrollment Taskforce meets to review data and facilities.</p> <p>Tasks administration with preparing multiple reconfiguration concepts</p>	<p>Enrollment Taskforce meets to review multiple concepts for reconfiguration of students and grades.</p> <p>Taskforce recommends that administration pursue planning on concept for:</p> <p>PK</p> <p>K-3 (2 schools)</p> <p>4-7</p> <p>8-12</p>	<p>District research study and analysis</p> <p>Presentation of preliminary information to Board of Education, PTO Presidents, and PTO Organizations.</p>

Timeline

Future

January, 2018	February, 2018	February - August, 2018
Taskforce to meet to review progress of preliminary planning effort. Meetings with the community Update to Board of Education	Tentative target for Board of Education decision	Continue planning and implementation.

Enrollment Trends



Enrollment Projection Methodology

FutureThink (2017)

Methodology for enrollment projection includes:

- Live birth data
- Historical enrollment
- Community school enrollment
- Open enrollment
- Community demographics
- Housing information



New Housing Information

FutureThink (2017)

HOUSING INFORMATION

The chart below illustrates the number of single-family dwelling building permits issued each year in Chardon City and Geauga County.

of Building Permits Issued for Single Family Dwellings

Year	Chardon City	Chardon Township	Hambden Township	Munson Township	Geauga County
2006	2	10	18	16	258
2007	4	7	19	17	226
2008	8	8	7	7	129
2009	4	3	1	12	62
2010	2	4	6	10	91
2011	4	5	3	13	102
2012	2	4	4	12	116
2013	10	3	8	17	137
2014	11	6	8	6	154
2015	11	9	7	10	132
2016*	6	4	9	12	111

Source: Geauga County Building Department; SOCDs Building Permits Database

* Chardon and townships through October 31, 2016; Geauga County through September 30, 2016

There are 30 platted lots and 56 unplatted lots in the Hidden Glen subdivision located in the City of Chardon. These homes are projected to be constructed in the next 5-10 years.

Additionally, Ryan Homes is working with local developers on a 122-home subdivision starting in 2018 or 2019. Ryan Homes projects to construct 20-25 new homes per year once the subdivision gets underway.



Enrollment Trends 1986-2027

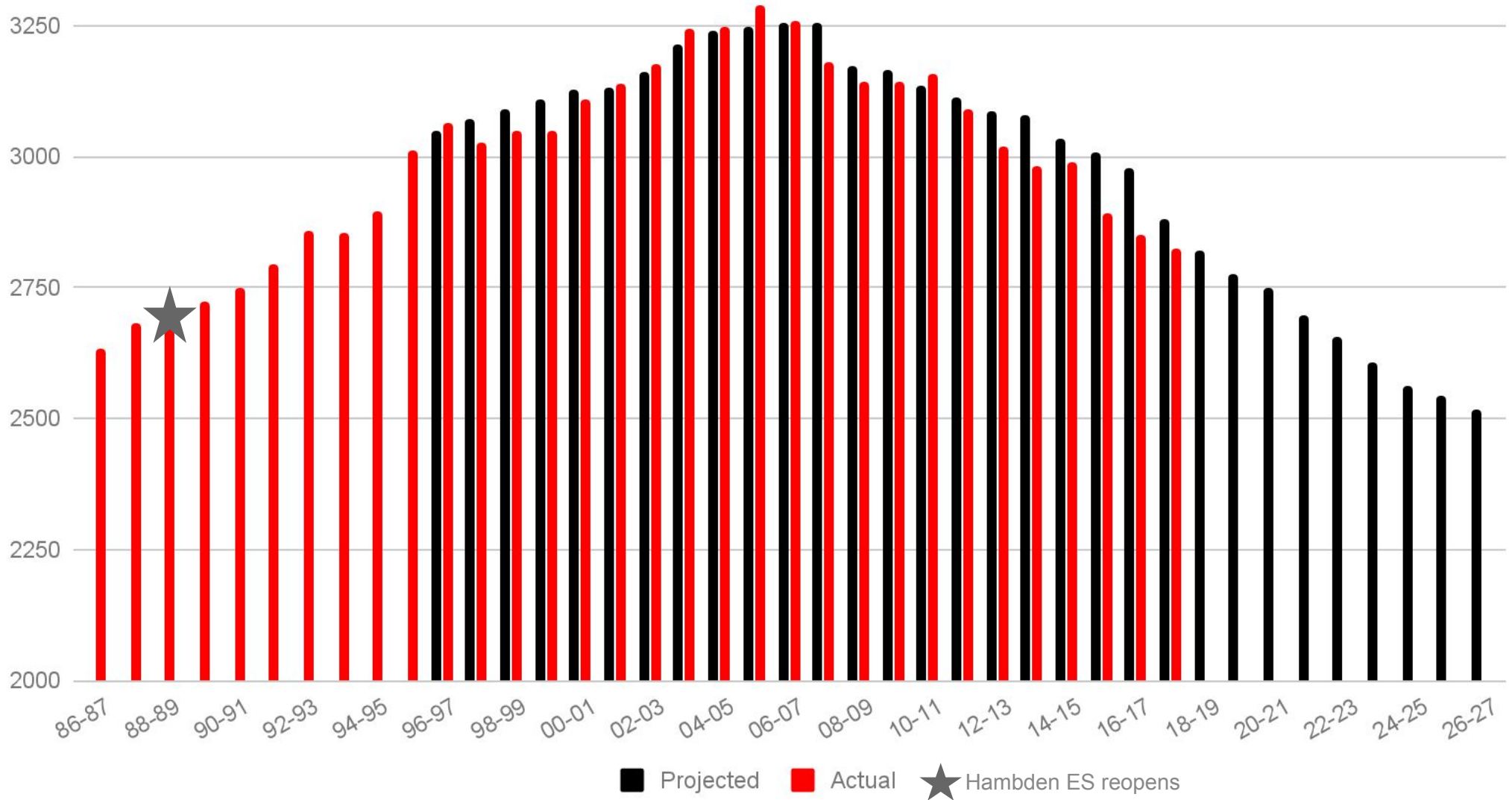

Area Districts

Enrollment Trends

DISTRICT	Enrollment 08/09	Enrollment 16/17
Chardon	3,143	2,823 (10%)
Berkshire	1,733	1,283 (26%)
Cardinal	1,345	1,042 (23%)
Kenston	3,163	2,756 (13%)
West Geauga	2,362	1,903 (19%)
Newbury	655	398 (39%)
Riverside*	4,945	4,192 (15%)



Area Districts

Reconfiguration Plans



CHARDON SCHOOLS

The News-Herald NEWS

News Sports Business Entertainment Lifestyle Obituaries Browns Indians M

Home News

Riverside School elementary school Township

12428 Concord Hambden Rd
12428 Concord Hambden Rd,
Painesville, OH 44077

View larger map

View Larger Map

By Tawana Roberts, The News-Herald

POSTED: 12/07/16, 11:44 AM EST | UPDATED: ON 12/07/16, 11:44 AM EST

A long-awaited question about the Riverside District Facilities Plan has been answered.

At the most recent School Board meeting, the Board announced that the location for one of the two new elementary schools will be at 12428 Concord Hambden Rd.

Administration Building May 2, 2017

To be approved at the Board of Education meeting May 24, 2017.

MINUTES OF THE MAY 2, 2017 SPECIAL MEETING OF THE BOARD OF EDUCATION.

The Mentor Exempted Village Board of Education held a Special Meeting on Tuesday, May 2, 2017, at 6:03 p.m., at the Helen H. "Sue" Osborn Administration Building, 6451 Center Street, Mentor, Ohio. Members present were: Superintendent, Mrs. Jeschelnic, Ms. Sally S. Miller, Mr. William J. Shaw, and Mrs. Bryner.

Mrs. Jeschelnic led the assembled in the opening prayer.

Mrs. Bryner moved, seconded by Mr. Shaw, that the Board consent agenda as presented by the Superintendent.

Acceptance of the following overnight file:

Mentor High School Science Olympiad Competition, Dayton, OH
May 18 - May 21, 2017

Roll Call: Ayes: Mrs. Bryner, Mr. Shaw, Ms. Miller
The motion carried.

Mr. Shaw moved, seconded by Ms. Miller, that the Board certify/licensed, and classified contract for the following:

CERTIFIED/LICENSED

Return from Leave of Absence for the following:

Andrews, Jilleena - Grade 2 Teacher/LA
Dorazio, Gina - Intervention Specialist/Intervention Specialist
Dwyer, Stephanie - ELA Teacher/Ridge
O'Donnell, Jessica - Grade 2 Teacher/LA
Rossi, Mary Beth - ELA Teacher/Shoreline

CLASSIFIED

The following will serve as We Care Institute staff:

Banas, Francesca
Kirchner, Beth Ann

Roll Call: Ayes: Mr. Shaw, Ms. Miller, Mrs. Bryner
The motion carried.

At this time Mr. Matthew J. Miller, Superintendent, presented a report on the school building needs. Three studies are under way to determine the best recommendation will be some combination of the three.

Ms. Miller moved, seconded Mrs. Bryner, that the Board executive session in accordance with OH Rev. Code 3301.06 and employment of a public hearing on the building needs study.

Roll Call: Ayes: Ms. Miller, Mrs. Bryner
The motion carried.

The News-Herald NEWS

News Sports Business Entertainment Lifestyle Obituaries Browns Indians

Home News

Wickliffe Schools reconfiguration nearing



Wickliffe Middle School will be converted into a K-6 building and the high school to a 7-12 facility in the 2018-19 school year. Students will be introduced to their new learning spaces in March. The News-Herald file

By Tawana Roberts, The News-Herald

POSTED: 12/15/17, 7:45 PM EST | UPDATED: 2 DAYS AGO

Wickliffe Schools' big transformation is just months away.

The school board has unanimously approved the reconfiguration of the school district from three buildings to two and a facility study to examine the potential for renovation/new construction of district facilities.

The current middle school will be converted to a K-6 building and the current high school to a 7-12 facility.

Although this will not be effective until the 2018-19 school year, the district will be working in the

District Facilities



District Facilities



Hambden

Acres 5.36

Built 1922

Additions 1949, 1964

SqFt 24,887

Classrooms **11**

Maple

Acres 4.2

Built 1958

Additions 1964

SqFt 26,520

Classrooms **12** full
2 smaller

Munson

Acres 15

Built 1955

Additions 1959, 1974

SqFt 31,228

Classrooms **16**

Park

Acres 1.49

Built 1938

Additions -0-

SqFt 44,000

Classrooms **19**

Chardon Middle School

Acres 78.5

Built 1965

Additions 1974

SqFt 89,224

Chardon High School

Acres 78.5

Built 1951

Additions 1953, 1957,
1964, 1974

SqFt 121,416

Facilities Committee

May 24, 2017



The Facilities Committee considered eight Master Plan concepts, and recommended the following District Master Plan:

- one PK to grade 6 or 7 building
- one grade 7 or 8 to grade 12 building

Grade 7 was seen as a “swing” year that could potentially fit in either facility.

A second recommendation from the Facilities Committee was for the District to pursue an operating levy prior to consideration of any bond issue for new school construction.

Reconfiguration Concept



Reconfiguration Concept



The Enrollment Taskforce considered 12 configurations

- Focus on grades K-5
- Dividing grade levels amongst buildings
- Additional transitions between buildings

The other configurations were rejected because:

- no increase in curricular benefits
- impractical transportation
- impact on parents of multiple children
- did not holistically address declining enrollment

Reconfiguration Concept

Maple - Preschool & ancillary uses

Munson - K-3

- enrollment projected similar to current trends

Park - K-3

- enrollment projected similar to current trends

CMS - 4-7

- 2018 enrollment projected to be approximately 90 more students than 2017
- 2019 enrollment projected to decrease below 2017 enrollment levels

CHS - 8-12

- 2018-2021 enrollment projected to increase by approximately 100-150 students
- 2021 onward enrollment projected to decrease below 2017 enrollment levels



Maple

12 Full Size Classrooms
2 Half-size Classrooms

Pre-K
(1-16)

Pre-K
(sensory room)

Pre-K (1-16)	Pre-K (1-16)
-----------------	-----------------

Pre-K (1-16)	Pre-K (1-16)
-----------------	-----------------

Pre-K (1-16)	Pre-K (1-16)
-----------------	-----------------

For illustration purposes only
Intra-district Boundary Line will determine actual class sections

Munson

16 Full Size Classrooms+Art/Music

1
(1:22 students)

1
(1:22 students)

1
(1:22 students)

1
(1:22 students)

2
(1:23 students)

2
(1:23 students)

2
(1:23 students)

2
(1:23 students)

Media Center

MD Classroom

3
(1:24 students)

3
(1:24 students)

3
(1:24 students)

3
(1:24 students)

K K

K K

ADED - K
(1:22 students)

Available Room

Art/Music Room

Park

18 Full Size Classrooms+Art/Music

1
(1:22 students)

1
(1:22 students)

1
(1:22 students)

1
(1:22 students)

2
(1:23 students)

2
(1:23 students)

2
(1:23 students)

2
(1:23 students)

Resource Room

Media Center

3
(1:24 students)

3
(1:24 students)

3
(1:24 students)

3
(1:24 students)

K K

K K

ADED - K
(1:22 students)

ADED - K
(1:22 students)

Support Room

Art/Music Room

Chardon Middle School

34 Full-Size Classrooms
 2 smaller classrooms
 2 Art classrooms
 1 MD classroom
 1 Music classroom
 1 Large Group Instr. Room
 (can be divided into 2)
 1 Gymnasium (with stage)

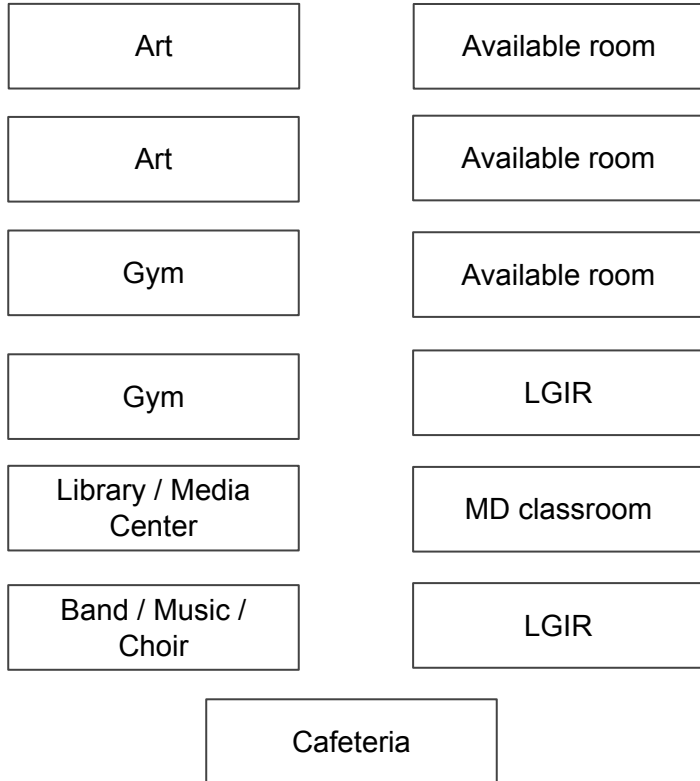

4 th	5 th	6 th	7 th
182	207	204	251

4 (1:23 students)	5 (1:26 students)	6 th ELA	7 th ELA
4 (1:23 students)	5 (1:26 students)	6 th Social Studies	7 th ELA
4 (1:23 students)	5 (1:26 students)	6 th Math	7 th ELA
4 (1:23 students)	5 (1:26 students)	6 th Science	7 th Social Studies
4 (1:23 students)	5 (1:26 students)	6 th ELA	7 th Math
4 (1:23 students)	5 (1:26 students)	6 th Social Studies	7 th Math
4 (1:23 students)	5 (1:26 students)	6 th Science	7 th Math
4 (1:23 students)	5 (1:26 students)	6 th Math	7 th Science

Chardon High School

41 Classrooms
 2 Art classrooms
 1 MD classroom
 1 Band classroom
 1 Choir classroom
 1 Gymnasium
 1 Auxiliary Gymnasium
 1 Cafeteria

MD classroom

Phys. Ed.

Band / Choir

Phys. Ed.

Theatre Arts

Cafeteria

Art

Art

Available Room

Media Center

8 th	9 th	10 th	11 th	12 th
251	236	260	231	240

8th ELA

9th ELA

10th ELA

11th ELA

12th ELA

8th ELA

9th ELA

10th ELA

11th ELA

12th ELA

8th Math

9th Math

10th Math

11th Math

12th Math

8th Math

9th Math

10th Math

11th Math

12th Math

8th Science

9th Science

10th Science

11th Science

12th Science

8th Science

9th Science

10th Science

11th Science

12th Science

8th Social Studies

9th Social Studies

10th Social Studies

11th Social Studies

12th Social Studies

8th Social Studies

9th Social Studies

10th Social Studies

11th Social Studies

12th Social Studies

Research & Analysis



Research & Analysis



Logistics and Operations

- Evaluation of building spaces
- Special education and gifted services
- Scheduling and school start times
- Transportation/Boundary planning
- School culture and climate
- Staffing needs
- Curricular alignment between grade-levels and departments

Research & Analysis

School culture and climate

- Student daily experiences
- Social experiences
- Grade interactions within school day
- Parental considerations
- For example: recess, dances, classroom parties, etc...

Work groups will be formed to identify and plan for student needs.



Similar District Configurations



District	Configuration	Student Enrollment	Rank
Solon	K-4, 5-8, 9-12	4,526	1
Madeira	K-4, 5-8, 9-12	1,418	3
Ottawa Hills	K-7, 8-12	907	7
Wyoming	K-4, 5-8, 9-12	1,898	8
Bay Village	K-2, 3-4, 5-8, 9-12	2,450	15
Canfield	K-4, 5-8, 9-12	2,655	24
Grandview Heights	K-3, 4-8, 9-12	1,065	26
Cuyahoga Heights	K-5, 6-12	743	39

Benefits to Students



Benefits to Students



Student Considerations

- Class sizes - stabilized across the District
- Opportunity for increased application of elective offerings (STEM, Art, Music, etc.)
- Opportunity for increased professional collaboration between teachers
- Better alignment of high school and middle school course offerings (243 units of HS credit currently being earned by 7-8th grade students)

Benefits to Students

Greater curricular opportunities for all grade-levels

Learning to Read

- Build on curricular focus on early literacy & numeracy development in K-3.

Reading to Learn

- Focus on content area reading and writing in middle grades.

Personalized Learning

- Opportunity for increased personalized educational experiences in grades 8-12
- Career Pathways, College Credit Plus, AP, and other courses



Teacher and Principal Perspectives

